

693

SIDE HINGE

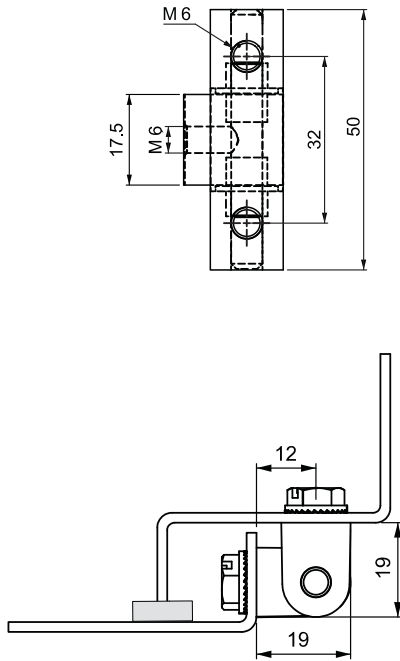

LH/RH



- Side mounted hinge.
- Stainless steel hinge pin. Supplied already assembled.

**APPLICATIONS**

Electric panels, machinery covers.

**MATERIAL**

Zamak DIN-EN 1774-ZnAl4Cu1

**Note:** Bolts are not given

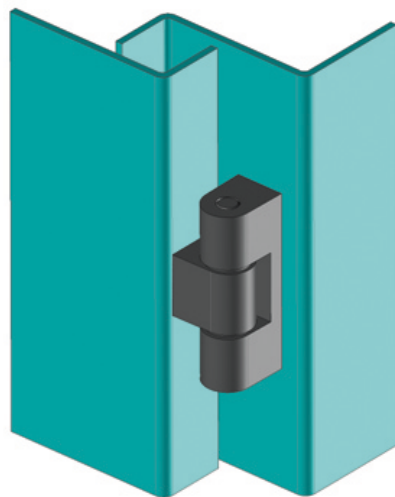

Hinge Rotation Angle

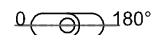

**PRODUCT CODE**

693 - 1 - F

GROUP CODE MATERIAL FINISH

MATERIAL	M	FINISH	F
Zamak	1	Chrome	1
		Black coated	2