



**CORPO / RUBBER PART**

**Materiale / Material**

Miscela gomma NR/SBR  
NR/SBR compound

**Standard / Standard**

Durezza 60 SHORE A  
60 Shore A Hardness

**A richiesta / On request**

Altre Durezze  
Different Hardnesses

**INSERTO / METAL PART**

**Materiale / Material**

Rondella sabbata e zincata  
Zinc plated washer

**Standard / Standard**

Inserto femmina cieco  
Threaded blind hole

**A richiesta / On request**

Inserto femmina passante  
Threaded through hole

**Tolleranza sulla durezza ±5 SH**

Hardness tolerance ±5 Shore A

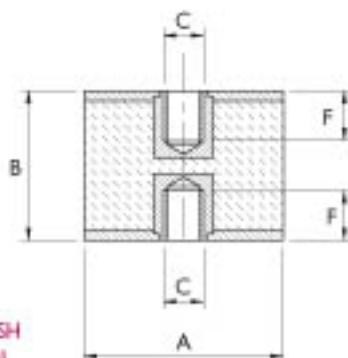

Carico max daN  
Maximum Load daN

Codice Code	A x B A x B	C x F C x F	Compress. Compress.	Taglio Shear
FF1515	15x15	M4x4	15	2
FF2020	20x20	M6x6	20	2
FF2025	20x25	M6x6	18	2
FF2030	20x30	M6x6	16	2
FF2520	25x20	M6x8	45	5
FF2525	25x25	M6x8	42	4
FF2530	25x30	M6x8	35	3
FF3020	30x20	M8x6	66	9
FF3030	30x30	M8x10	61	8
FF3040	30x40	M8x10	54	5
FF4030/8	40x30	M8x10	98	15
FF4030/10	40x30	M10x10	98	15
FF4035/8	40x35	M8x10	108	13
FF4040/8	40x40	M8x10	108	13
FF4040/10	40x40	M10x10	108	13
FF5030	50x30	M10x10	169	19
FF5040	50x40	M10x10	144	17
FF5050	50x50	M10x10	134	13
FF6030/10	60x30	M10x10	210	30
FF6030/12	60x30	M12x12	210	30
FF6040/12	60x40	M12x12	210	30
FF6050/10	60x50	M10x10	200	24
FF7540	75x40	M12x12	378	78
FF7550	75x50	M12x12	373	68
FF10050	100x50	M16x14	660	98
FF10055	100x55	M16x14	636	78
FF10060	100x60	M16x14	590	49